



# AMIX



*A breathtaking*  
innovation

AIRMASTER

# AMX

Ventilation  
Heating  
Cooling  
*all in one*

## **Ventilation. Heating. Cooling. All in one.**

Introducing our revolutionary innovation, the AMX - the perfect all-in-one solution that combines reliable indoor ventilation with comfortable indoor temperature. The AMX integrates ventilation and heat recovery and incorporates a reversible air-to-air heat pump for optimal indoor climate control. With improved insulation standards in construction changing temperature needs, AMX provides great ventilation, heating and cooling in just one system.

## **Take charge of your indoor climate**

AMX is designed for a quick and easy installment and requires minimal maintenance, making it a hassle-free and cost-effective solution for your needs. With its intuitive and user-friendly interface, control is effortless. Moreover, it can be seamlessly connected to Airlinq, allowing you to take charge of your indoor climate from your mobile or tablet device.

## **Boost indoor climate. Reduce energy bill**

AMX ensures optimal atmospheric and thermal comfort while reducing energy consumption and utility costs by efficiently conditioning incoming air. Its intelligent control logic regulates cold or warm air, optimizing both ventilation and energy usage. Additionally, the use of natural refrigerant R290 in the heat pump significantly minimizes environmental impact.

## **Comforting indoor silence**

AMX is designed with a low sound level to be placed indoors with no distracting compressor noise. Moreover, the versatile design allows for seamless integration into most building types, including low buildings with the option of ceiling mounting.







# AMX

Ventilation  
Heating  
Cooling  
*all in one*

## Leaving behind the old energy solution

To supply a room with ventilation, heating or cooling you traditionally need three different energy sources. A ventilation unit, which can be central or decentral, a heating supply such as a radiator, a cooling unit such as a split cooler with a chiller on the roof. Together these three supply units can be very complex to control and costly to install and increase the energy cost while running three different systems. Below is displayed a typical room with individually supply of ventilation, heating, and cooling. This leaves you with a room where it can be difficult to control the indoor climate and it looks messy.

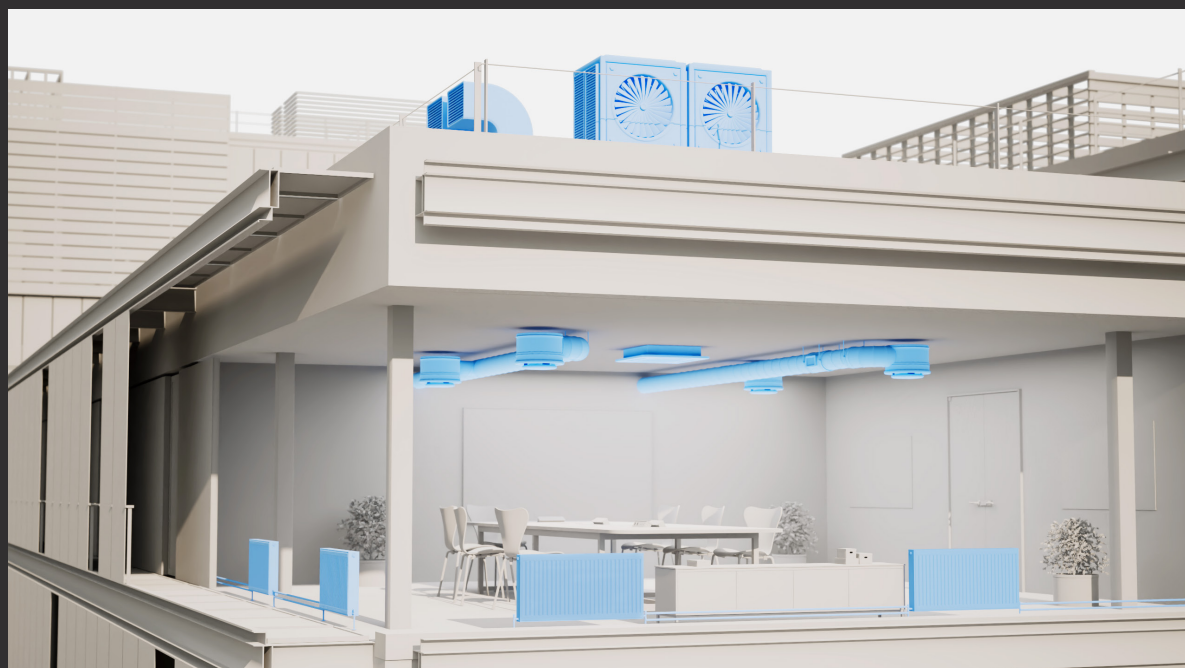

## Ready for one indoor climate solution

The quiet AMX replaces above three energy sources and you have only one indoor climate solution with ventilation, heating, and cooling. This reduces installation cost because you only have one installation, and at the same time your operating cost will be reduced because of the intelligent built in control system, this ensures that AMX only uses energy when needed. The iconic and uniquely designed AMX takes up less space in the room and looks very clean and welcoming - a unique solution for an optimal climate solution.



# AMX

## Unique controlling

AMX is designed to run automatically for an optimal indoor climate with ventilation, heating, and cooling in one. AMX is developed so it will operate in the most efficient operating mode depending on the inside and outside air quality and temperature.

Below is a short overview which displays different operating modes of AMX. These modes will be controlled automatically, by the unique AMX controlling system, depending on the needs for ventilation, heating, cooling or recirculating for an optimal indoor climate.

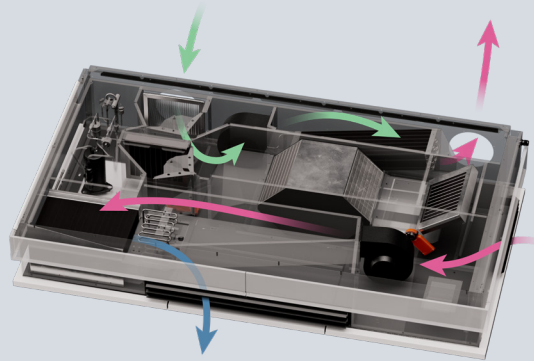

## Recirculating heating

Room temperature is cold and outside temperature is temperate cold. AMX heats up the room - no fresh air is needed.

## Recirculating cooling

Room temperature is warm, and outside temperature is temperate warm. AMX cools down the room - no fresh air is needed.

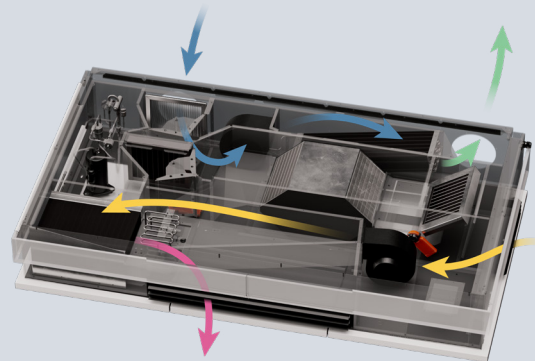

## Ventilation Bypass with cooling

The room temperature is warm, and the outside temperature is temperate. AMX cools down and ventilates the room with fresh air bypassing the heat exchanger.

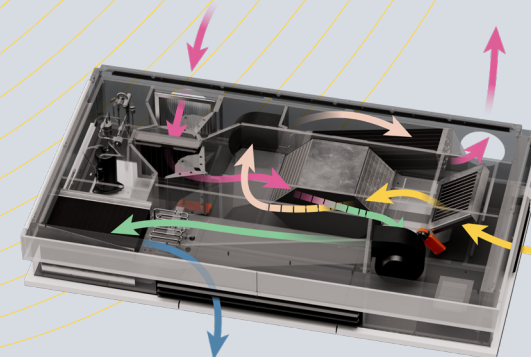

## Ventilation and cooling

Inside and outside temperature is warm. AMX cools and ventilates with fresh air.

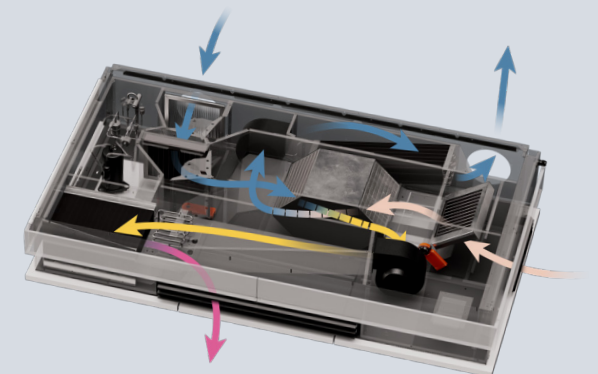

## Ventilation and heating

The outside temperature is cold, and the room temperature is temperate. AMX warms and ventilates with fresh air.

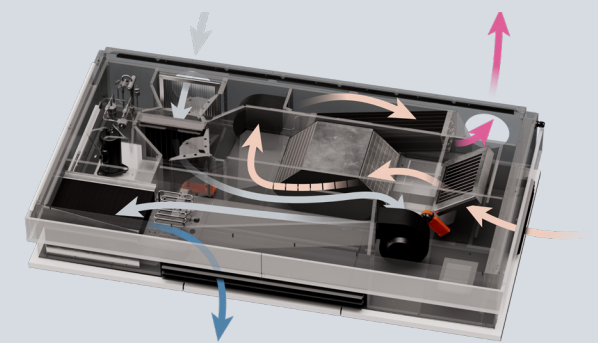

# AMX

## Measurements

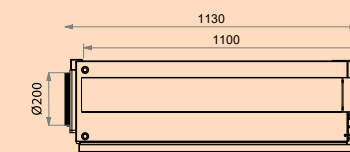
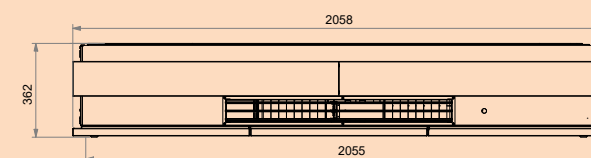
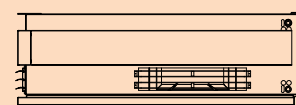

Technical data	Filter class	30 dB(A)	35 dB(A)
Maximum capacity	ePM <sub>10</sub> 50%	222 m <sup>3</sup> /h	288 m <sup>3</sup> /h
	ePM <sub>1</sub> 55%	220 m <sup>3</sup> /h	284 m <sup>3</sup> /h

Electrical heating surfaces	Heating surface 1	Heating surface 2
Heat output	1150 W	1150 W
Nominal current	5 A	5 A
Thermal circuit breaker, manual reset	100°C	100°C

Heat pump	
Nominal cooling output	2000 W
Nominal heat output	2300 W
Materials: pipes / fins	Copper /Aluminium
COP (heating) ventilation	5.7 - 7.4
COP (heating) recirculation	3.6
EER (cooling) ventilation	2.3 - 3.8
Refrigerant / GWP	R290 / 3
Filling	330 g

### Standards and options

Counterflow heat exchanger (Aluminium)	x	Supply air filter ePM <sub>10</sub> 50%	Opt.
Motor-driven bypass	x	Supply air filter ePM <sub>1</sub> 55%	Opt.
Motor-driven supply air damper	x	Supply air filter ePM <sub>1</sub> 80%	si
Motor-driven extract air damper	x	Extract air filter ePM <sub>10</sub> 50%	x
Electric heating surfaces	x	LED (operating mode indicator)	x
Condensate pump	x	Wall/ceiling bracket	x
Electronic humidity sensor (built-in)	x	External connection module	Opt.
PIR/motion sensor (wall mounted)	Opt.	Airmaster Airlinq® Online	Opt.
PIR/motion sensor (integrated)	Opt.	Airlinq® Online API	Opt.
CO <sub>2</sub> sensor (wall mounted)	Opt.	Bluetooth app	x
CO <sub>2</sub> sensor (integrated)	x		
TVOC sensor (integrated)	x		

x: standard opt.: optional si: special item



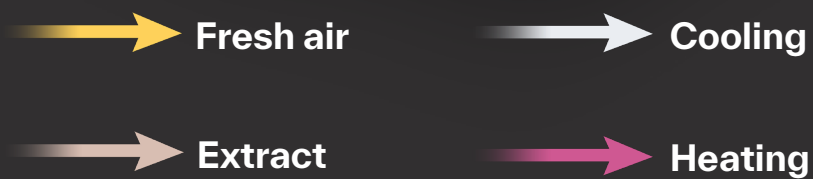
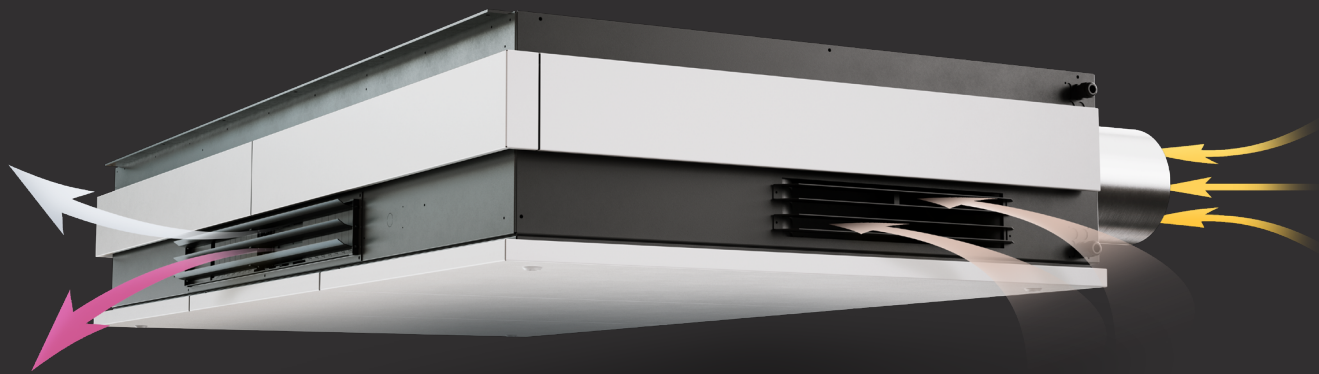

### AMX Facts

- Compact, decentralized (ductless) heat recovery and ventilation system with reversible air-to-air heat pump
- Energy-efficient fresh air cooling and heating as needed
- Recirculation mode for energy saving
- Reversible heat recovery, both heating and cooling mode
- Intuitive and simple user interface
- Flexible and modular with many communications options
- Connection to Airlinq online
- Advanced control logic for climatization with warm or cold air
- Low sound level
- Low building height suitable for ceiling mounting
- Heat pump with natural refrigerant R290
- Installation of AMX can be done without authorization
- There is no outside part

For further information, please refer to the technical data sheet.

**AIRMASTER**